

For Residential and Commercial Applications

Job Name		Engineer / Architect	
Job Location		Wholesaler	
Submittal Date		Contractor	

MOMTWH3/4IPS Tankless Water Heater Hot/Cold Service Valves

Use: For use in potable water distribution systems for water flow control. Valves connect directly to coldwater inlet and hot water outlet of the tankless water heater. Use for appliance maintenance and emergency shut-off.

Design Features:

- **Compact design** ideal for recessed and cover box installations
- **Captive coupling nut & washer** reduces opportunity for component loss making installation easier
- Captive washer won't kink or tear during installation
Forged, one-piece construction reduces the potential for pinhole leaks
- Integrated drain valve with independent, ¼ turn operation allows quick system diagnostic testing and maintenance
- Built-in side port for the pressure relief valve reduces the number of connections & simplifies the installation
- Right-sized handles, color-coded for immediate system identification Perfect for tight installations
- 100% Lead Free for potable water

Operating Specifications:

Temperature: 40° - 180° F

Pressure: 125 PSI maximum

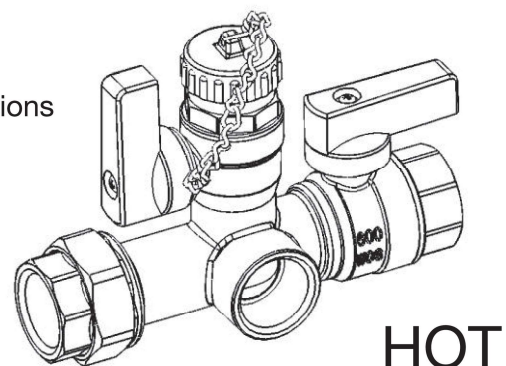

HOT

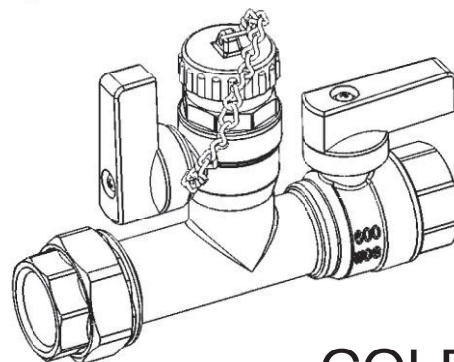

COLD

VALVE MATERIAL SPECIFICATIONS

Body	Forged brass
Stem	Brass
Handle	Aluminum, coated
Handle Screw	Steel, zinc plated
Flat Seal	Rubber
Coupling Nut	Forged brass
Drain Cap	Forged brass
Cap Gasket	Rubber
Seat	PTFE
Ball	Brass, chrome plated



Maid-O'-Mist®

Manufacturing the finest plumbing products since 1932.

www.maidmist.com • 773-685-7300 ©2020 Maid-O'-Mist

MOMTWH3/4IPS Tankless Water Heater Hot/Cold Service Valves

Part Listing:

- ☐ **MOMTWH3/4IPS/IPS STD**
Tankless Water Heater connection w/ 3/4" X 3/4" IPS to IPS threaded connection
Includes a standard T and P vent
- ☐ **MOMTWH34IPS/SWTSTD**
Tankless Water Heater connection w/ 3/4" X 3/4" IPS to sweat connection
Includes a standard T and P valve
- ☐ **MOMTWH3/4IPS/IPSEXT**
Tankless Water Heater connection w/ 3/4" X 3/4" IPS to IPS threaded connection
Includes an extended probe T and P valve
- ☐ **MOMTWH3/4IPS/SWTEXT**
Tankless Water Heater connection w/ 3/4" X 3/4" IPS to sweat connection connection
Includes an extended probe T and P valve

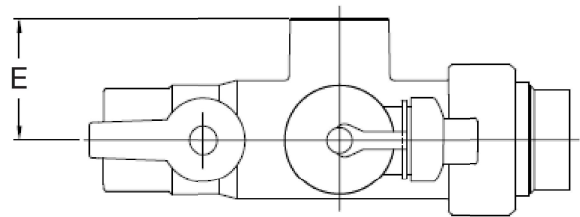
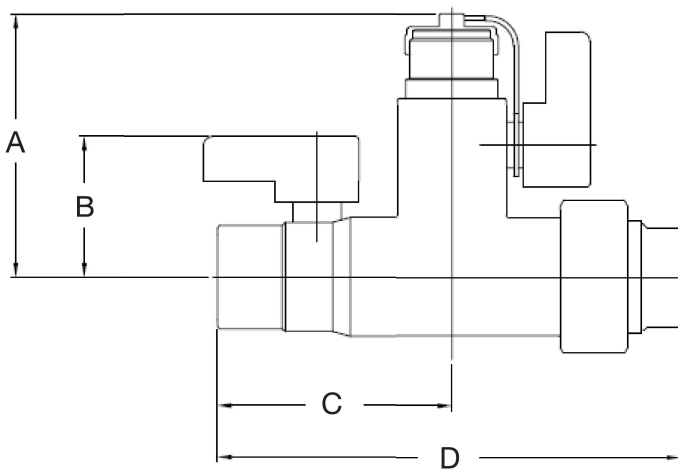

PART SPECIFICATIONS (Inches)					
Model	DIM. A	DIM. B	DIM. C	DIM. D	DIM. E*
MOMTWH3/4IPS/IPS STD	3.03	1.76	2.60	5.61	1.09
MOMTWH34IPS/SWTSTD	3.03	1.76	2.60	5.61	1.09
MOMTWH3/4IPS/IPSEXT	3.03	1.76	2.60	5.61	1.09
MOMTWH3/4IPS/SWTEXT	3.03	1.76	2.60	5.61	1.09

*Dimension for hot valve with pressure relief valve port

Listings and Certifications:

- IAPMO listed to IAPMO/ANSI Z1157 including NSF/ANSI 14



This specification and all information contained herein is the confidential and exclusive property of Brasscraft Manufacturing Company and shall not be disclosed to others without the written consent of Brasscraft Mfg. Co. This specification must be returned to Brasscraft Mfg. Co. if requested.



Maid-O'-Mist®

Manufacturing the finest plumbing products since 1932.

www.maidmist.com • 773-685-7300 ©2020 Maid-O'-Mist